

WHAT'S IN THE BOX

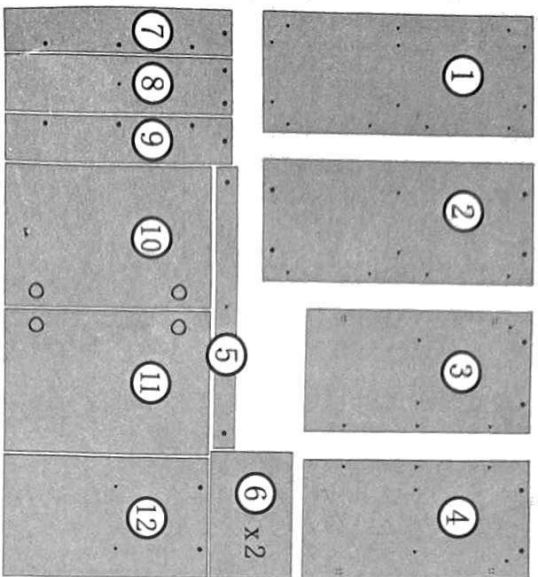

FITTINGS

	Pin	x19
	Cam	x19
	Hinge	x4
	Hinge Screw	x24
	Foot	x6
	Latch Screw	x6
	Panel Screw	x10
	Shelf Support	x8

PANELS

①	Top	⑤	Top Cross	⑨	Right Back
②	Base	⑥	Shelf	⑩	Left Door
③	Left Side	⑦	Left Back	⑪	Right Door
④	Right Side	⑧	Centre Back	⑫	Centre Panel

Securing with Cams and Pins



Adjusting Fittings

Hinges

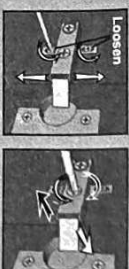

Read and follow all safety instructions and important notices in these instructions as well as on the product itself.

ASSEMBLY STEPS

